



rtc[®]

COUPLING TECHNOLOGY
www.rtc-tec.com



072

rtc TYPE



Temperature Range - Temperaturbereich
-20°C +100°C (-4°F +212°F) Nitril (N)
-10°C +180°C (+14°F +356°F) FPM (V)

Max. Working Pressure - Max. Betriebsdruck
rtc 072.05 400 bar (5800 PSI)
rtc 072.06 400 bar (5800 PSI)
rtc 072.10 375 bar (5450 PSI)
rtc 072.12 350 bar (3625 PSI)
rtc 072.16 350 bar (5075 PSI)

Flow size - Nennweiten
rtc 072.05 5 mm
rtc 072.06 6 mm
rtc 072.10 10 mm
rtc 072.12 12 mm
rtc 072.16 16 mm

Material
Socket Body- Kupplungsgrundkörper Steel zinc plated - Stahl verzinkt
Sleeve - Hülse Steel zinc plated - Stahl verzinkt
Valve - Ventil Steel zinc plated - Stahl verzinkt
Springs - Federn Stainless steel - Edelstahl
Seal - Dichtung Nitrile (N)
Balls - Kugeln Stainless steel - Edelstahl

Plug - Nippel Steel zinc plated - Stahl verzinkt

Using Area
- On hydraulic oil circuits
- Hydraulic test units
- Injection moulding industries / core pullers

Anwendungsbereiche
- Hydraulische Verbindungen
- Hydraulik Prüfstände
- Kunststoffindustrie / Kernzüge



Flow Rate vs Pressure Drop Graph / Durchflussrate vs Druckabfall

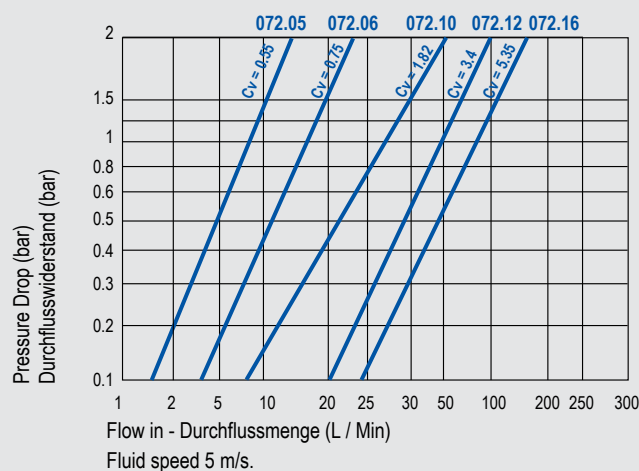

072
rtc TYPE

rtc TYPE 072

Female thread socket / Kupplung mit Innengewinde



Socket / Kupplung

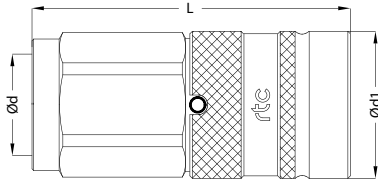

Size / Größe	Order No / Bestellnr.	Ød	Ød1	L	HEX.
05	072.05 SFB 10	BSP 1/8	20	40	19
06	072.06 SFB 13	BSP 1/4	28	58	27
10	072.10 SFB 17	BSP 3/8	32	69	30
10	072.10 SFB 21	BSP 1/2	32	74	30
12	072.12 SFB 21	BSP 1/2	38	84	36
16	072.16 SFB 26	BSP 3/4	42	84	41

rtc TYPE 072

Female thread plug / Nippel mit Innengewinde

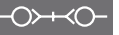

Plugs / Nippel

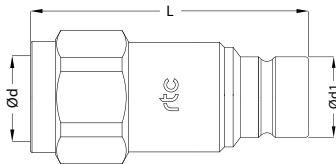

Size / Größe	Order No / Bestellnr.	Ød	Ød1	L	HEX.
05	072.05 PFB 10	BSP 1/8	11.5	35	17
06	072.06 PFB 13	BSP 1/4	16	54	22
10	072.10 PFB 17	BSP 3/8	20	60	27
10	072.10 PFB 21	BSP 1/2	20	63	27
12	072.12 PFB 21	BSP 1/2	24.5	71	36
16	072.16 PFB 26	BSP 3/4	27	73	36

MULTI COUPLING TECHNOLOGY



www.rtc-tec.com

QUICK COUPLING TECHNOLOGY



Water

Pneumatic

Hydraulic

Electrical

Accessories